

plaster ring Ø38

installation instruction

1

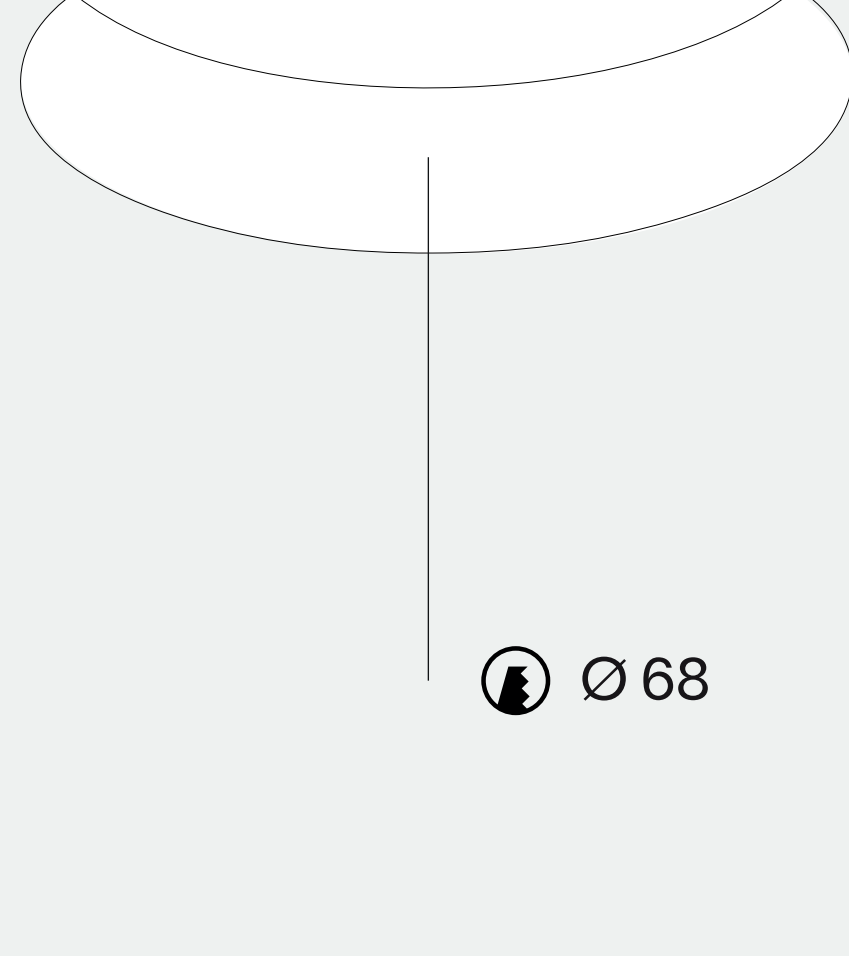

Cut a round hole (Ø 68). Consult the chosen luminaire tech specs for required height and free air dimensions.

2

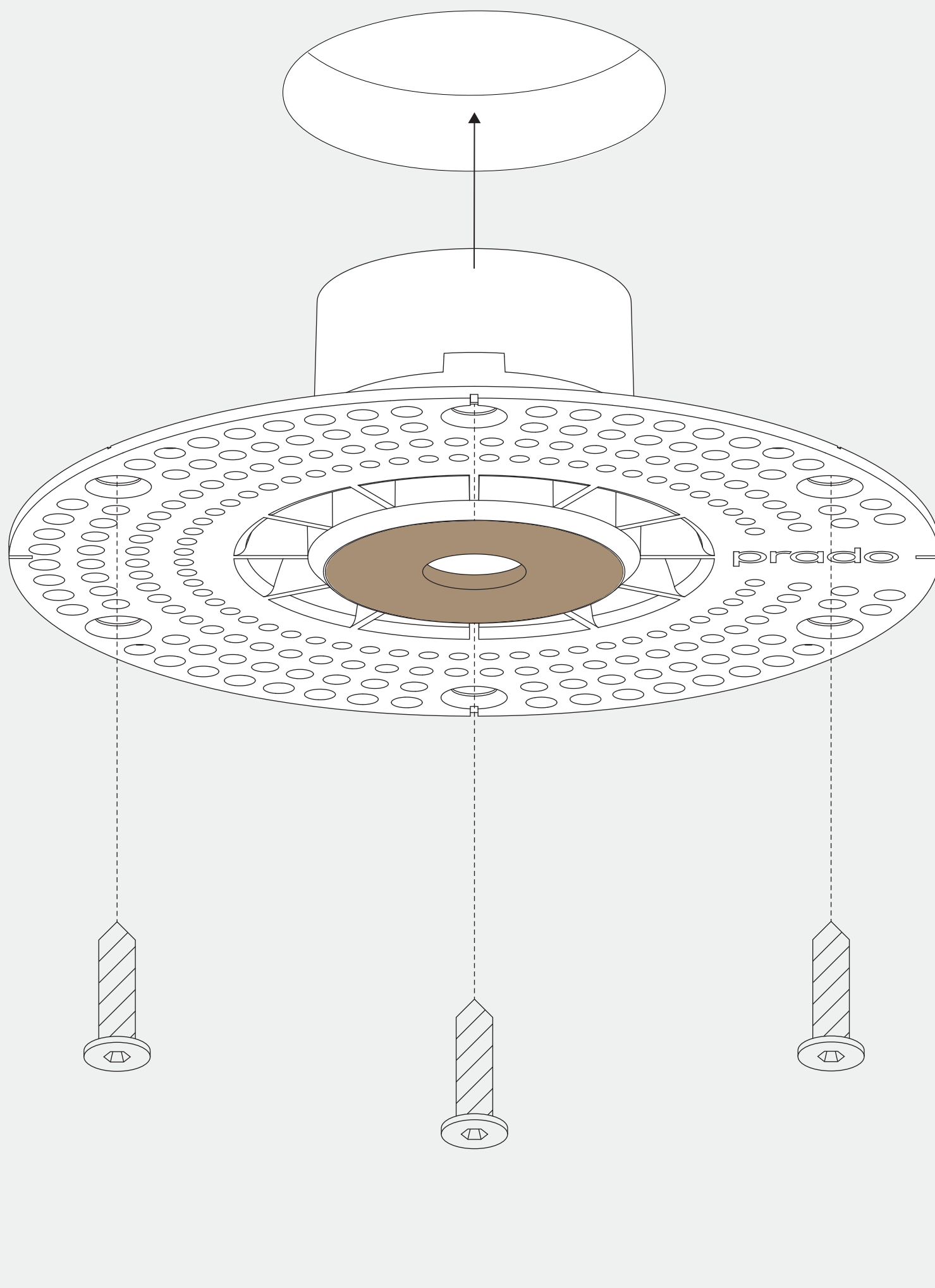

Insert the plaster ring and securely fasten it with glue or the appropriate screws on a screwfast surface. The attachment must be able to obtain a static load of 5 kg. It's the installers responsibility to ensure optimal attachment.

3

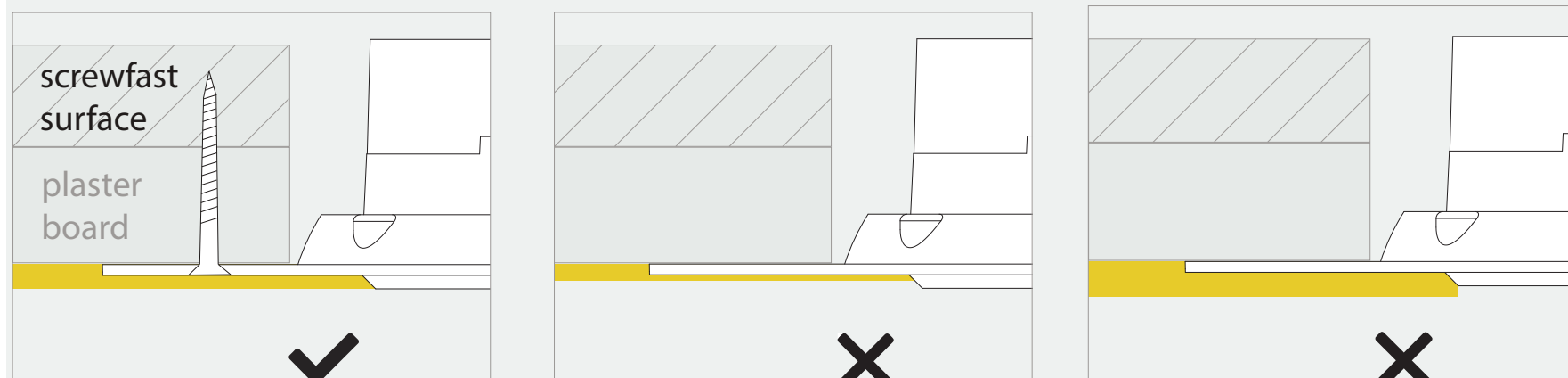
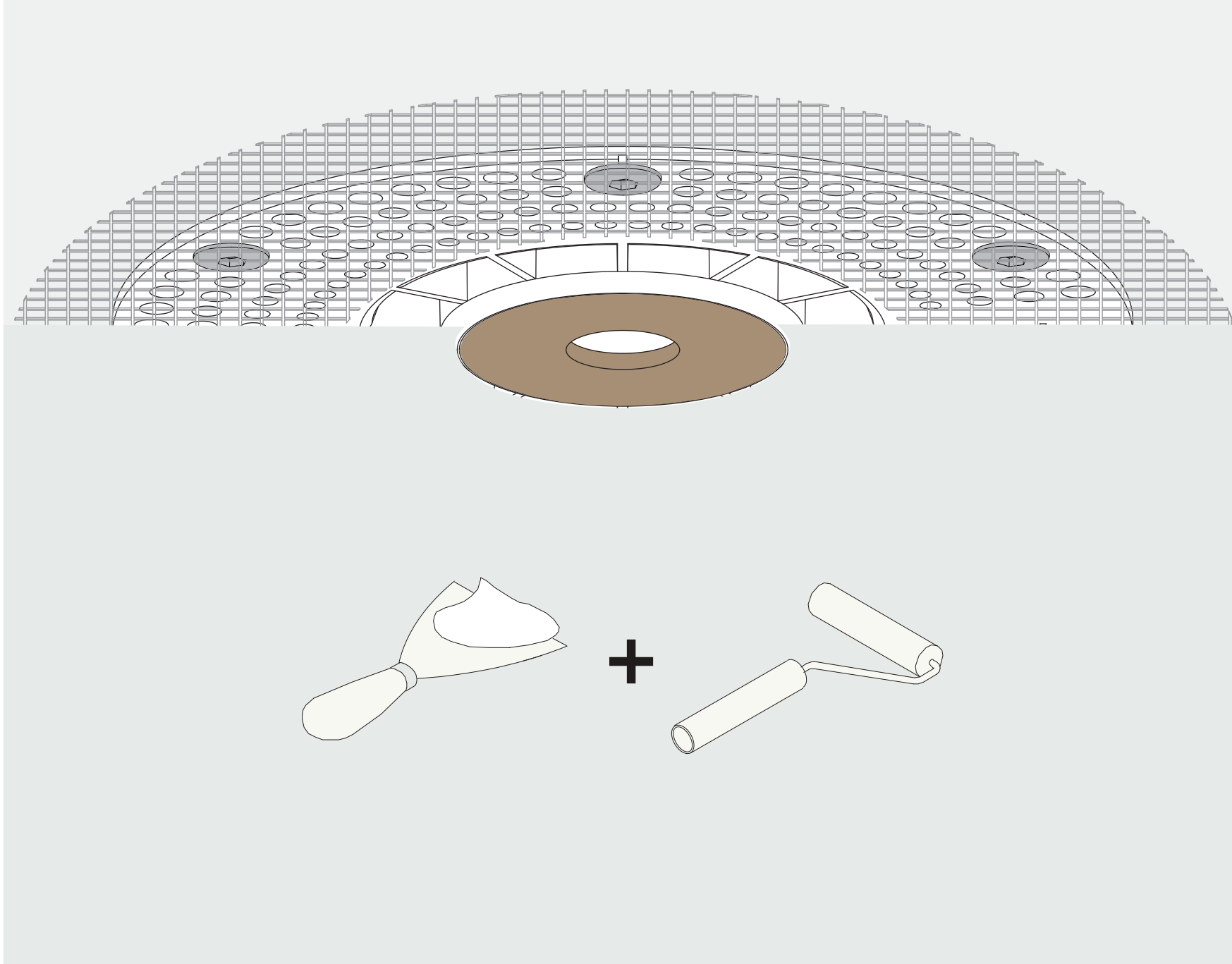

perfect amount of plaster

not enough plaster

too much plaster

Exercise caution while plastering, do not damage the ring. Keep the plaster lid inside the plaster ring while plastering. Use a fiberglass mesh tape for optimal plaster adhesion. Make sure not to touch the edge of the ring when sanding.

4

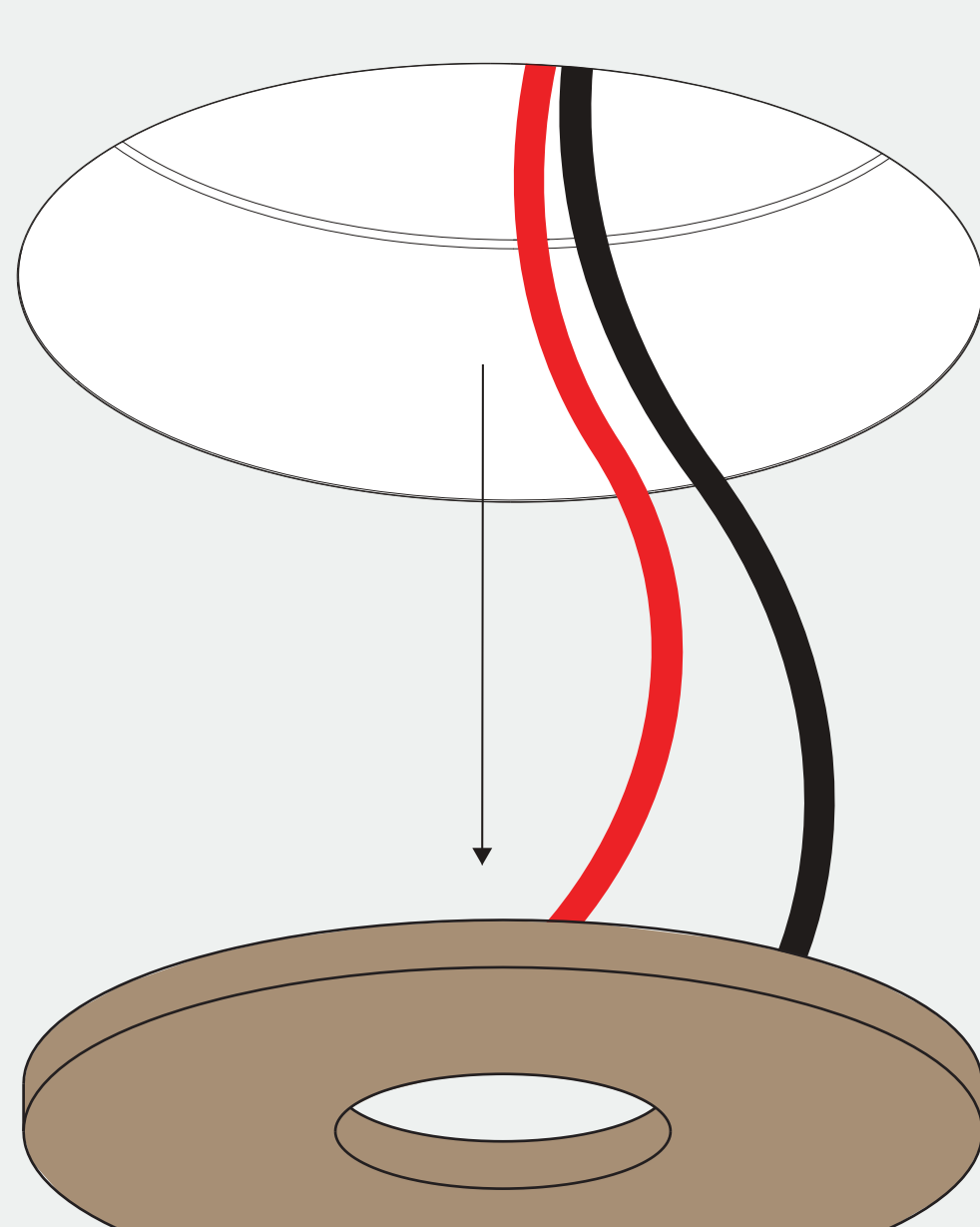

Remove the plaster lid before installing the fixture. Any residue needs to be removed without damaging the edges of the ring.

thank you for choosing prado